



communication module PROFINET High-Feature with integrated switch

product brand name	SIRIUS
product category	Communication modules
product designation	Communication module
design of the product	PROFINET High Feature with integrated switch
manufacturer's article number of soft starter	3RW55
•	
<b>General technical data</b>	
reference code according to IEC 81346-2	A
Substance Prohibitance (Date)	02/11/2019
SVHC substance name	Lead monoxide (lead oxide) - 1317-36-8 4,4'-isopropylidenediphenol (Bisphenol A, BPA) - 80-05-7
<b>Installation/ mounting/ dimensions</b>	
mounting position	any
fastening method	screw fixing
height	126 mm
width	28 mm
depth	82 mm
weight without packaging	0.1 kg
<b>Ambient conditions</b>	
installation altitude at height above sea level maximum	5 000 m; Derating as of 1000 m, see catalog
ambient temperature	
• during operation	-25 ... +60 °C; observe derating of basic unit above 40 °C
• during storage and transport	-40 ... +80 °C
environmental category	
• during operation according to IEC 60721	3K6 (no ice formation, only occasional condensation), 3C3 (no salt mist), 3S2 (sand must not get into the devices), 3M6
• during storage according to IEC 60721	1K6 (only occasional condensation), 1C2 (no salt mist), 1S2 (sand must not get inside the devices), 1M4
• during transport according to IEC 60721	2K2, 2C1, 2S1, 2M2 (max. height of fall 0.8 m)
<b>Electrical Safety</b>	
protection class IP on the front according to IEC 60529	IP20
touch protection on the front according to IEC 60529	finger-safe, for vertical contact from the front
<b>Approvals Certificates</b>	
General Product Approval	



[Confirmation](#)



EG-Konf.



UL



ous locations

[KC](#)

[other ex-certificates](#)

[Type Test Certificates/Test Report](#)



Marine / Shipping other Environment Industrial Communication



[Confirmation](#)

[Environmental Confirmations](#)

[PROFINET](#)

Further information

Information on the packaging

<https://support.industry.siemens.com/cs/ww/en/view/109813875>

Information- and Downloadcenter (Catalogs, Brochures,...)

<http://www.siemens.com/ic10>

Industry Mall (Online ordering system)

<https://mall.industry.siemens.com/mall/en/en/Catalog/product?mlfb=3RW5950-0CH00>

Cax online generator

<http://support.automation.siemens.com/WWW/CAXorder/default.aspx?lang=en&mlfb=3RW5950-0CH00>

Service&Support (Manuals, Certificates, Characteristics, FAQs,...)

<https://support.industry.siemens.com/cs/ww/en/ps/3RW5950-0CH00>

Image database (product images, 2D dimension drawings, 3D models, device circuit diagrams, EPLAN macros, ...)

[http://www.automation.siemens.com/bilddb/cax\\_de.aspx?mlfb=3RW5950-0CH00&lang=en](http://www.automation.siemens.com/bilddb/cax_de.aspx?mlfb=3RW5950-0CH00&lang=en)

Characteristic: Tripping characteristics, I<sub>t</sub>, Let-through current

<https://support.industry.siemens.com/cs/ww/en/ps/3RW5950-0CH00/char>

Characteristic: Installation altitude

<http://www.automation.siemens.com/bilddb/index.aspx?view=Search&mlfb=3RW5950-0CH00&objecttype=14&gridview=view1>

Simulation Tool for Soft Starters (STS)

<https://support.industry.siemens.com/cs/ww/en/view/101494917>

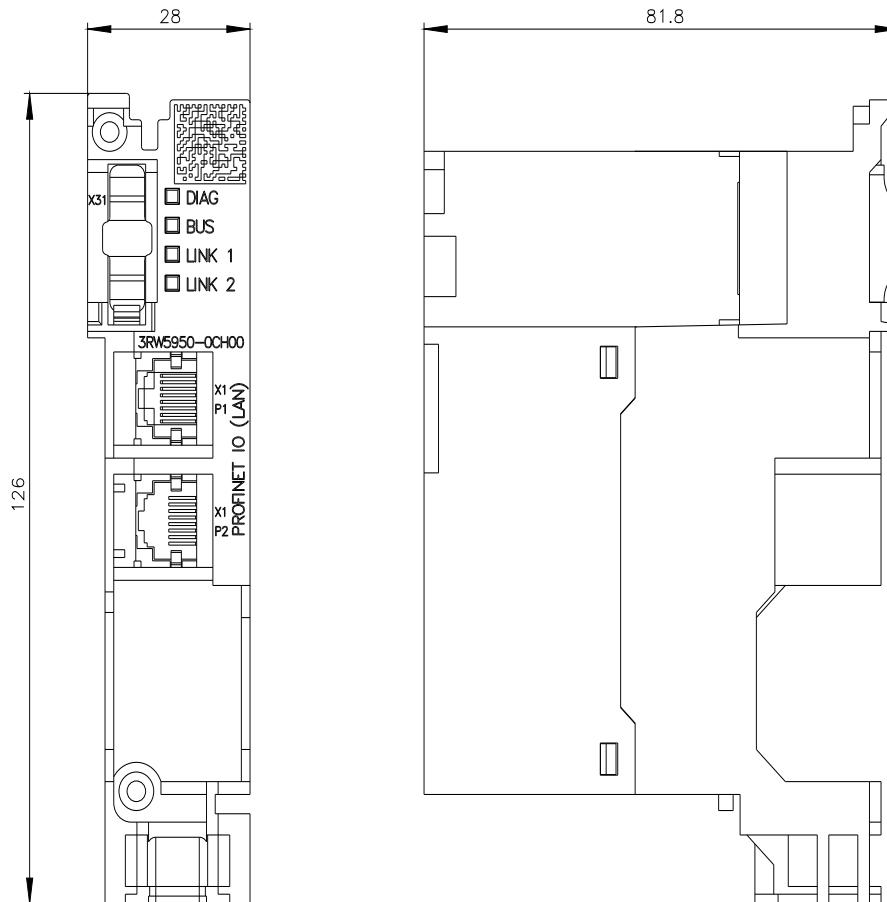

-A

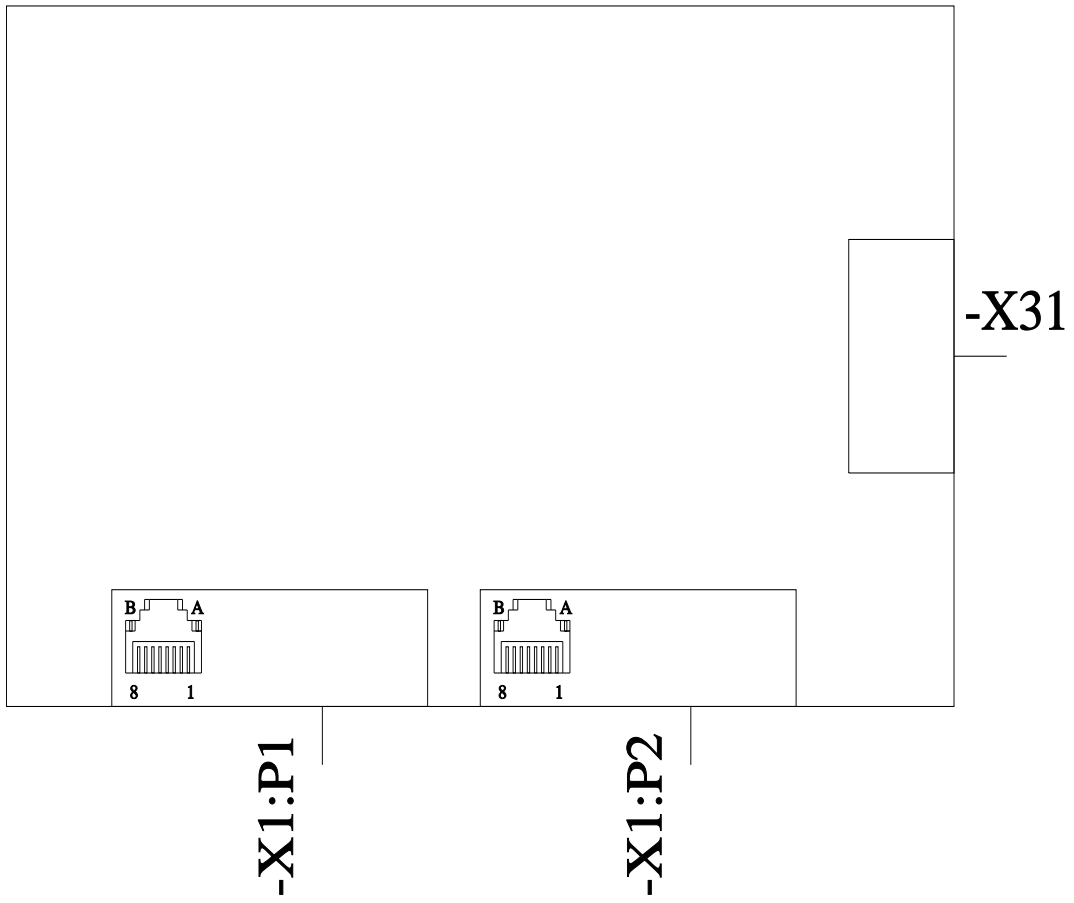

last modified:

3/11/2024 

